

C009

DIY mini house kits - DoRaMi



C009 Instruction manual

NOTICE OF ASSEMBLE

Making tips

1. LED wiring indication: White=Positive; Grey=Negative.
2. Use a craft blade to carefully skim over the plastic to bare the copper wire.
3. For LED wiring extension, please refer to the below steps:

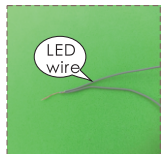
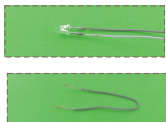

Twist the copper of both LED wire and extension wire together.

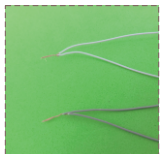

Do the same on the white wire.
Remarks: Tie a knot at the end of the grey wire to differentiate the polarity.

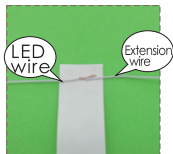

Place the duly twist wire on the tapes provided.



Roll and wrap the wire.

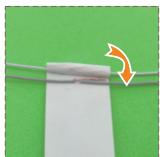

Place another wire next to it.
Remarks: DO NOT contact both copper wire to avoid short circuit.

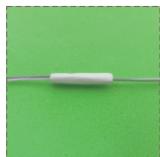

Roll and wrap it together.

Warnings

- The product is not suitable for children under 14 years old. The should be under custody of adults when playing with the product.
- There are small parts, please do not swallow them for avoiding dangerous accidents.

Tips for assembling

1. Pictures shown on the package may be slightly different from the actual product.
2. Please use the provided tracing paper for cutting purpose to achieve the best outcome.
3. Product designs and specification may be subject to change without advance notice for purpose of making improvement.
4. Testing on LED function:

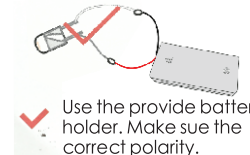

How to assemble the battery holder



1. Material and tools needed:
- Battery holder, LED bulb, tape, screw driver and 2 piece AA size battery (not provided)



2. Use screw driver and take the lid off from the battery holder.

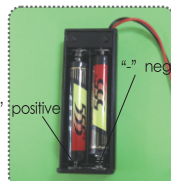

"+4" positive

"-4" negative

3. Insert the battery take notes on the polarity.

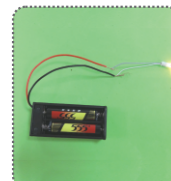

4. Connect the red wire to grey wire. Connect the black wire to white wire.

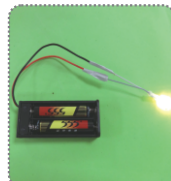

5. Wrap the exposed wire with the tapes.

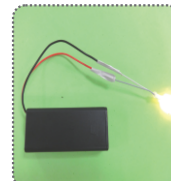

6. Place the box lid and fastness with screw driver.

Product information



white doll machine



pink doll machine



wall lamp

white doll machine

pink doll machine

ladder

pink baby

WHO ARE YOU

I think you need something

wall deco

table

push

push

potted plant



potted flower

railing

I LIKE PINK

potted flower



chair

display board

potted plant

potted plant



potted plant



potted plant

Doll

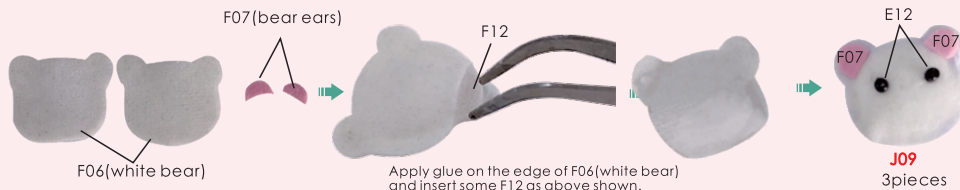
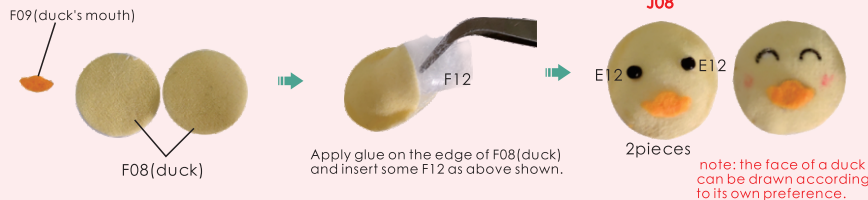
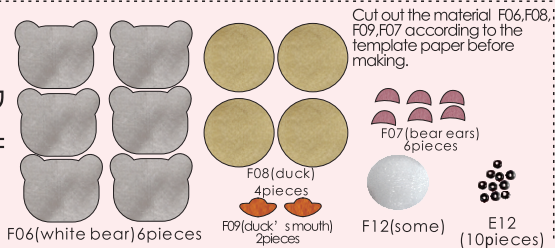

White doll machine
 E12 (1 piece)
 E09 (1 piece)
 E13 (1 piece)

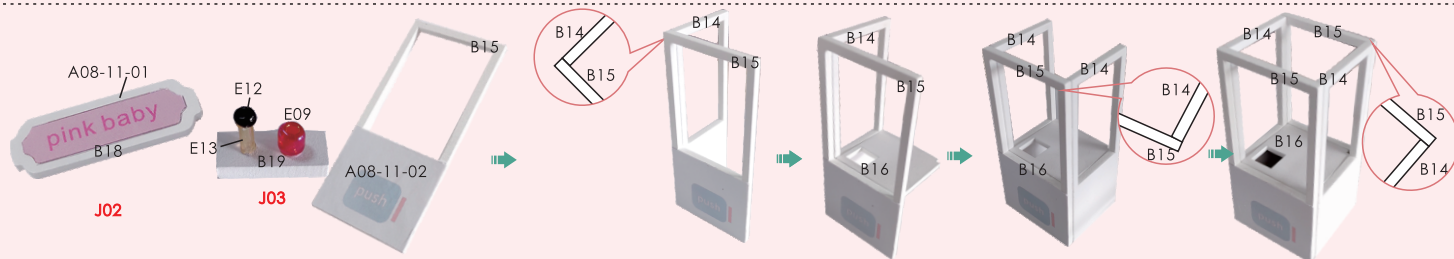
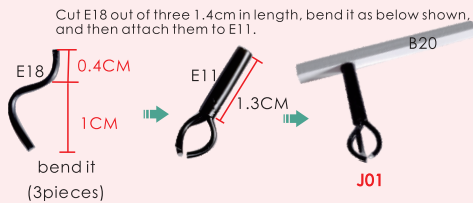
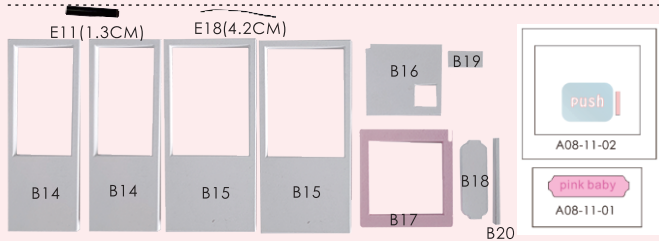

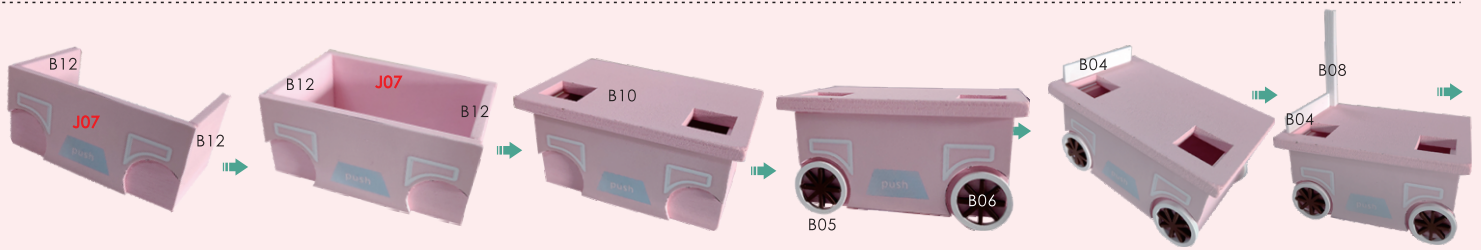
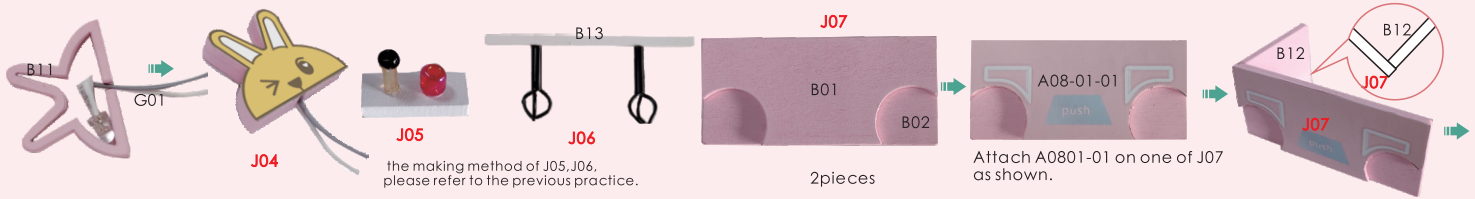
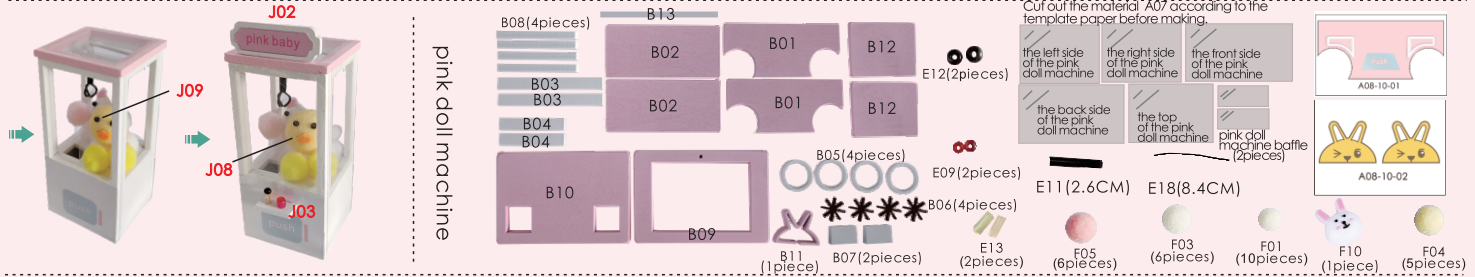

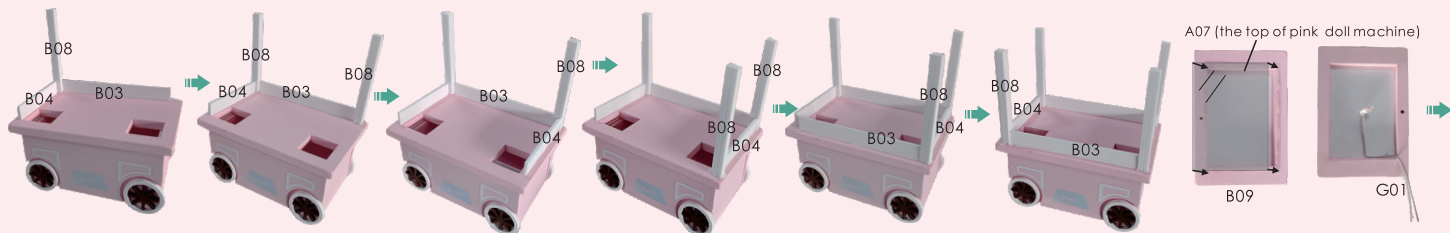

the dotted line is a schematic diagram of lamps.



Above step is same as the white doll machine.

Potted plant



J14



J15



Attach E14 and E15 on E19 as above shown.

J12



cut E07 out of 4*1 cm, cut it as above shown.



Roll E07 with E19, cut off the excess as shown.

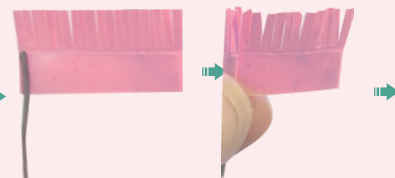

2pieces

J18



Table and chair

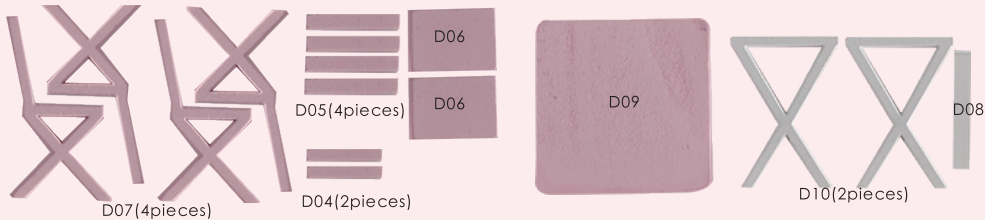

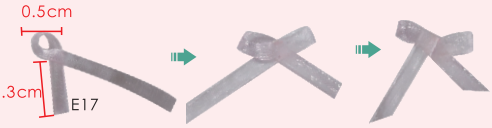
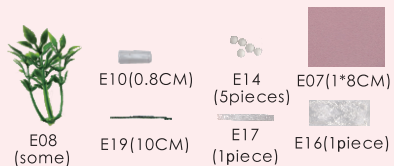

Following above steps to make the bowknot, cut off the excess.

E08(2/3 of a branch)



the making method of flower is same as page 5.

the length of E19 is between 0.8-1.6cm, need 5pieces.

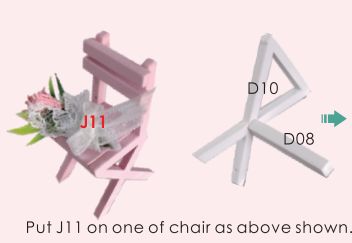
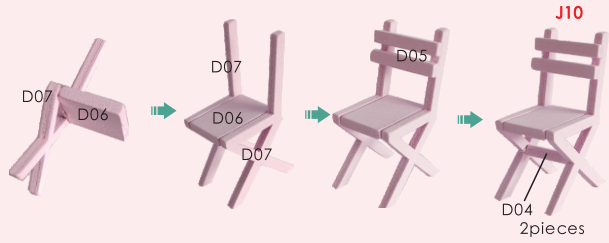

Put J11 on one of chair as above shown.

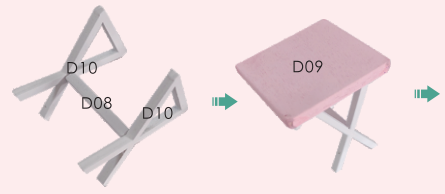

Table

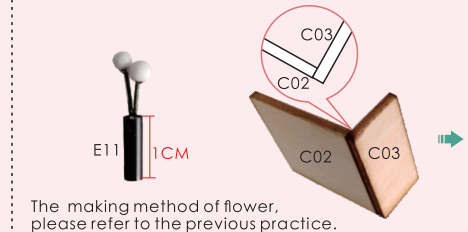

The making method of flower, please refer to the previous practice.

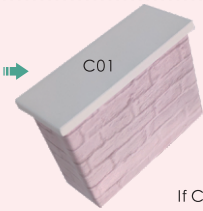
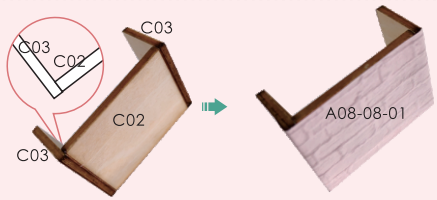

High chair

If C05 cannot be inserted, it can be polished on sandpaper.

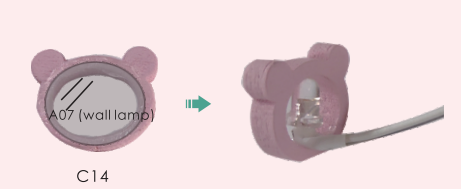
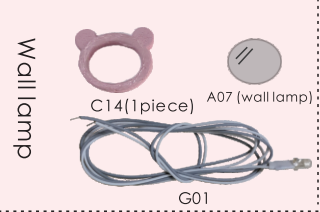
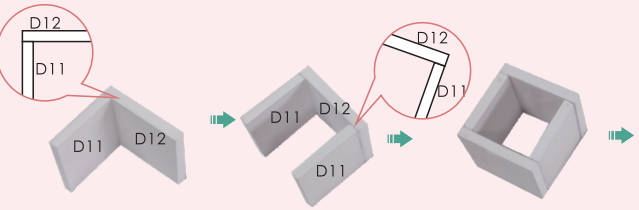
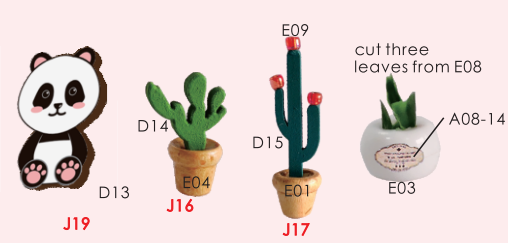
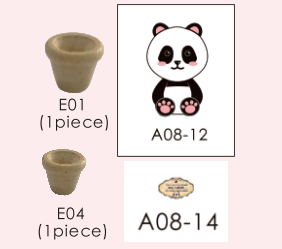
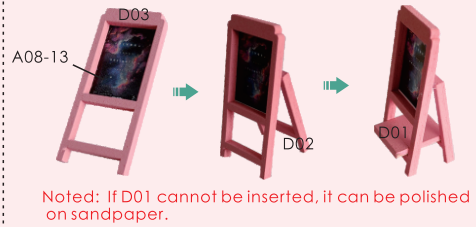
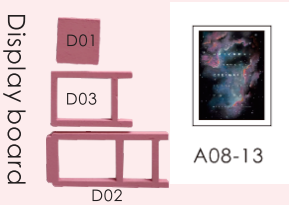
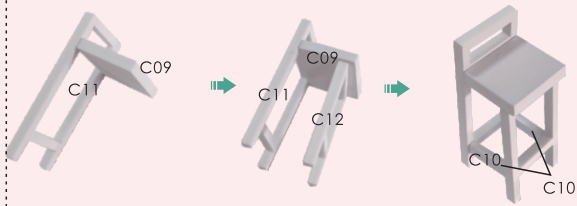
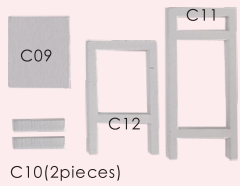

Outer frame

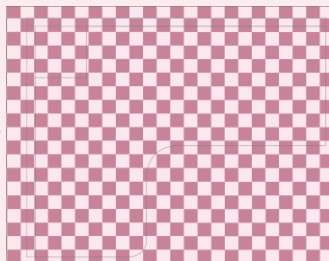
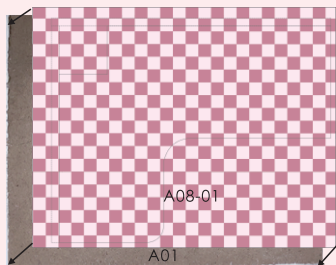

J20

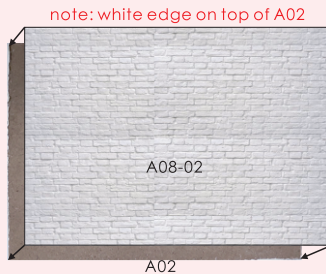

J21

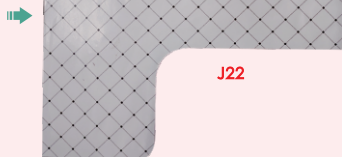
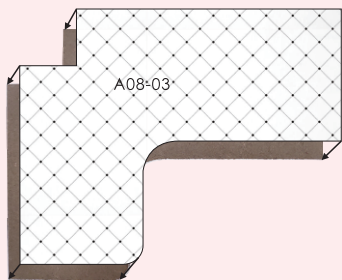

J22

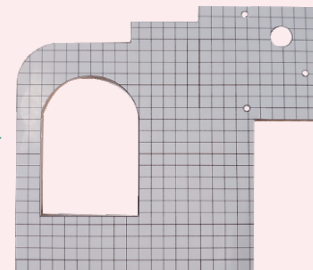
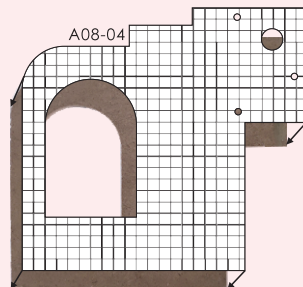

J23

Noted: If C16 cannot be inserted, it can be polished on sandpaper.

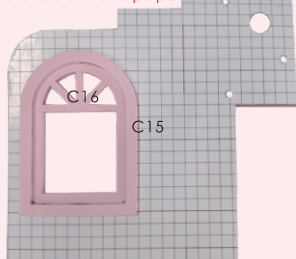

J23

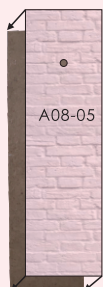

J24



(front view)



(back view)

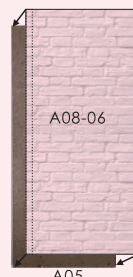

J25

Note: cut a opening on A05 with a knife as shown.

Music machine core manual guide
(If you have purchased the music machine core, please fix it firstly)

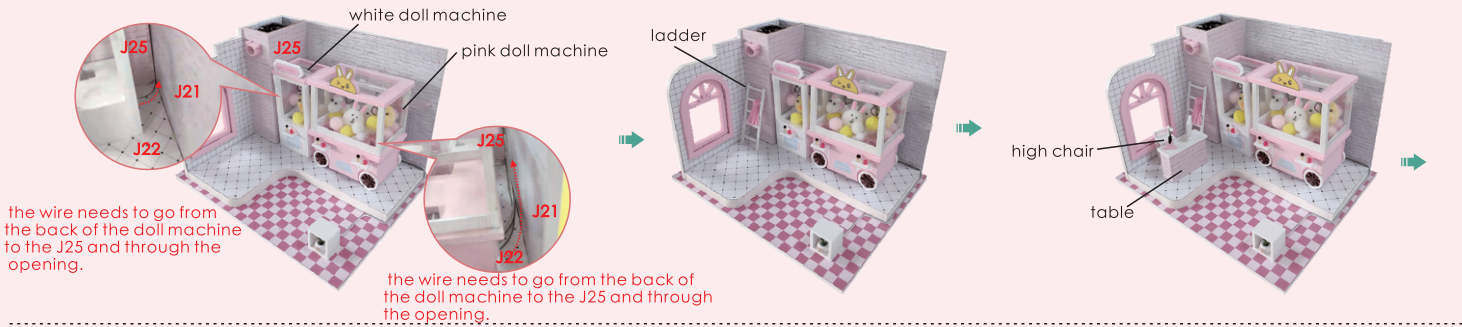
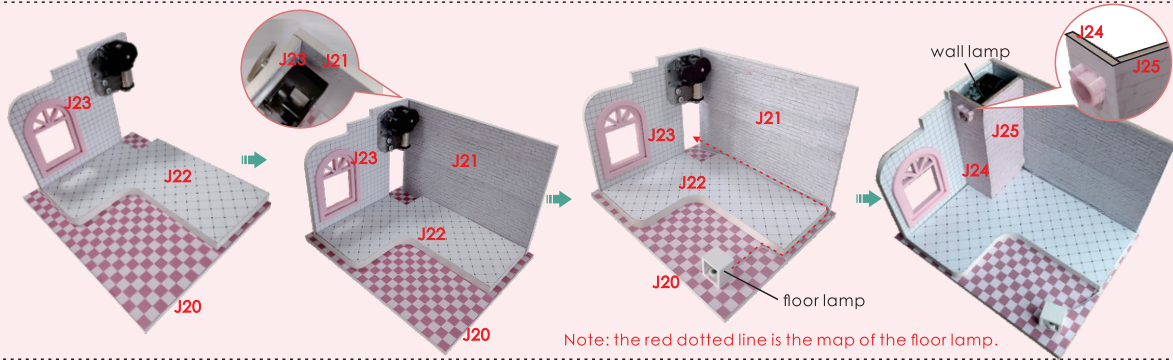

A08-07



How to assemble the battery holder

Statement: the lamp wires cannot be inserted into the output socket.

- Can use 2 piece AAA size battery
- Please notice the place of anode and cathode when put in the batteries
- Rechargeable batteries are not blunt electricity
- Rechargeable batteries can only be charged under adult supervision
- Rechargeable batteries should be removed from the toy before charging
- Different types of batteries cannot mix; Do not mix new batteries in use with semi-used batteries.
- Run out of battery should be removed from the toy
- The power shall not be short circuit

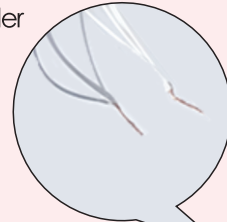

Trim all the LED wiring to the same length.



Use a craft blade to carefully skim over the plastic to bare the copper wire. Twist the same color wire together.

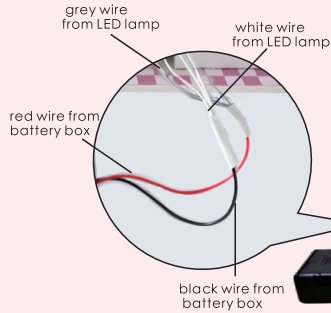

Twist the following wire together:
 (I) BLACK wire from the battery box with the WHITE wire from LED bulb.
 (II) RED wire from the battery box with the GREY wire and blue wire from LED bulb.



Roll and seal the duly twist copper with the white tape G03 provided. Place the battery box in the allocated space.

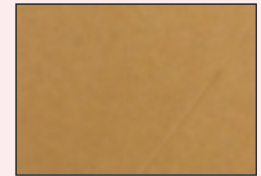

scale 1: 6
 H04 transparent cover
 19*13.5*0.15cm
 2pieces

Installation of dust proof cover (For updated version, the parts need to be purchased separately)



scale 1: 6
 H05 transparent cover
 14.7*13.5*0.15cm
 2pieces

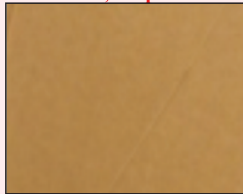

scale 1: 6
 H06 transparent cover
 19*15*0.15cm
 1piece



1. Tear off kraft paper of each piece of transparent cover.

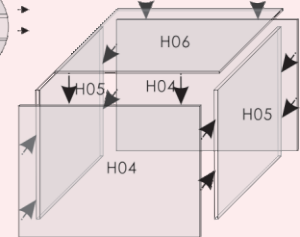
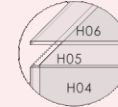

2. Paste H04, H05 and H06 together to complete the dust proof cover as shown.

Photo of Dust proof cover



Attention: Please keep the instruction for future enquires after installation.